

GCM101-A 2848 Approx. 1280 Sq. Ft.

● = Std. can light

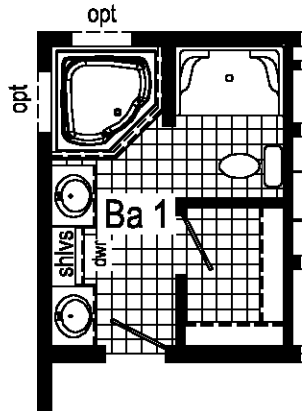

Optional
Glamour
Bath

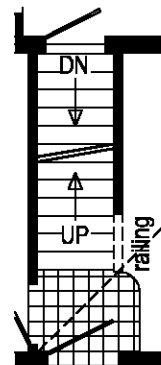

Optional
Stairwell
(omits g.c.)

Richland Elite Cape Modular

Revisions	
Date	Number

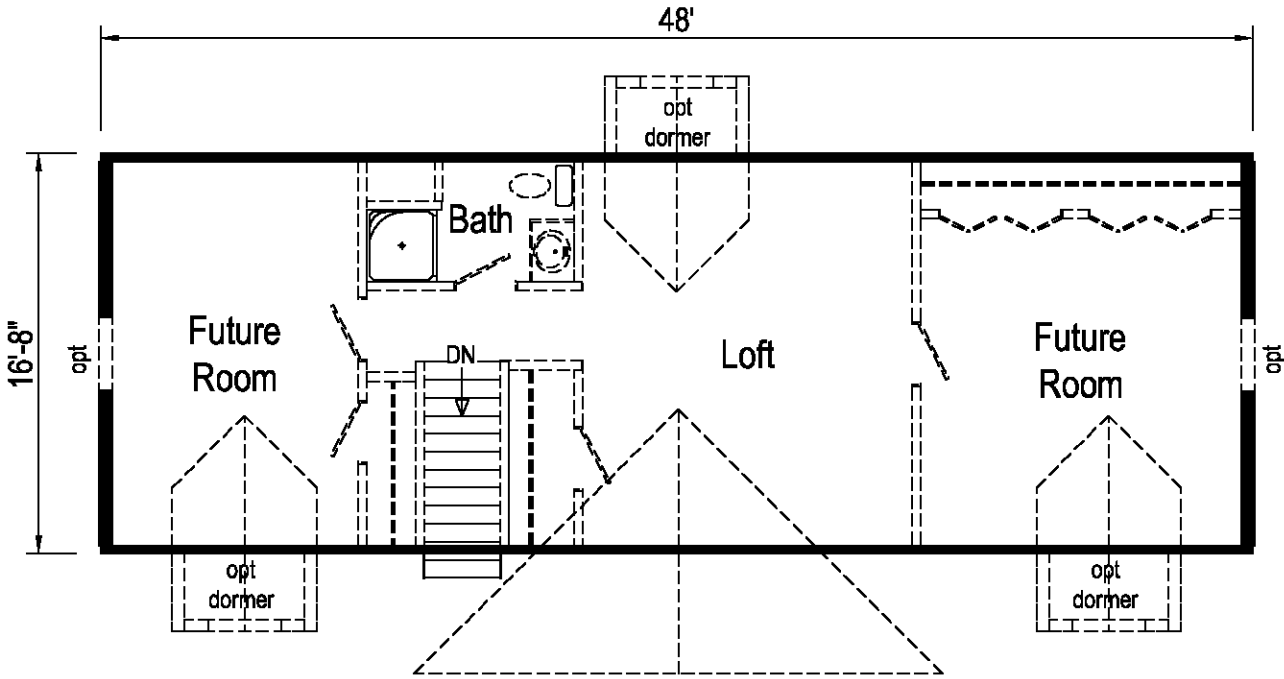

Second Floor Approx. 800 Sq. Ft.

Proposed Second Floor:
 All design materials and work to be the responsibility of the builders on site to local codes. Light, vent, egress, heating and plumbing are the responsibility of the builder.

Richland Elite Cape Modular

GCM101-A 2848 Approx. 1280 Sq. Ft.

Builder: Commodore Homes of Pennsylvania	Callout: 2848	Revisions		Scale: 1/8" = 1'-0"	Date: 7/7/16	Cust: -	Model/Eng. No.: GCM101-A
		Date	Number				
Title: Literature				Drawn By: OY	Reference: GC101-A	Dir: -	Pg.: LIT2