

GF900-A

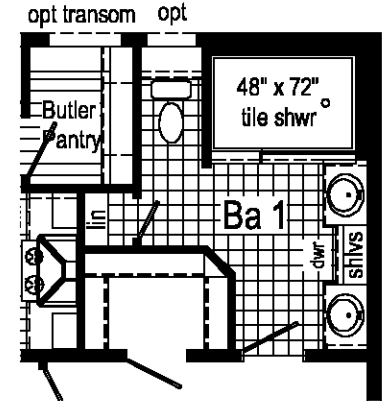
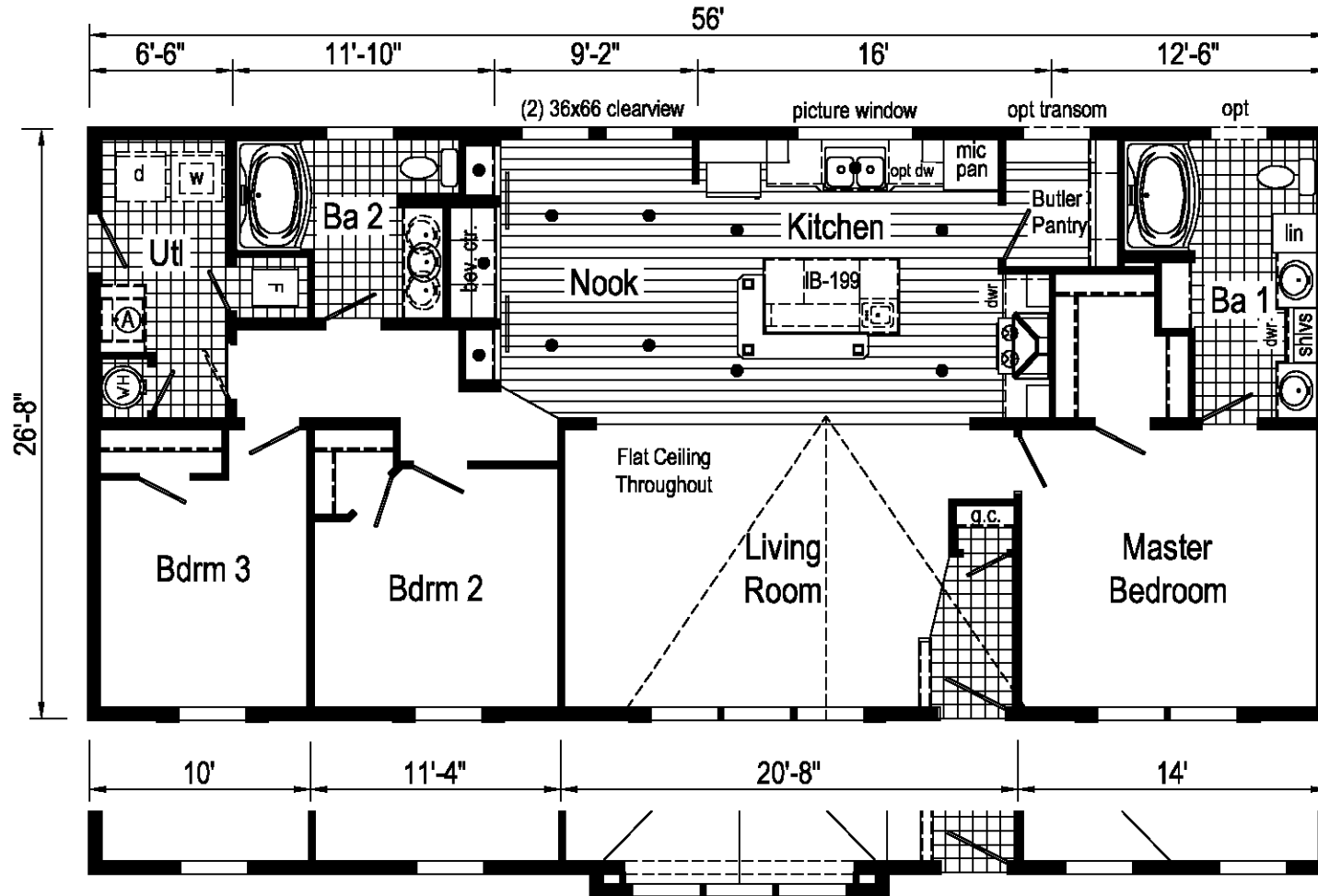

**Optional 4' x 6'
Walk-In Tile Shower**

Opt. 26'-8" dormer w/ bump-out

Curb Side Exterior Options

GF900-A 2856 Approx. 1493 Sq. Ft.

Ⓐ = std frz spc or opt util sink.

● = Std. can light

Richland Elite Model

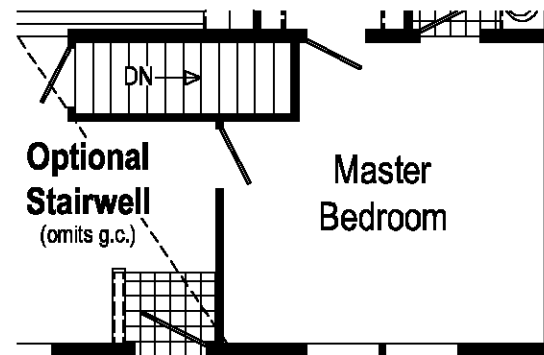

Revisions	
Date	Number
7-8-15	