

The Eastwood

3 Bedroom

2 Bath

14 x 72 (68) / 907 s.f.



www.GoVillageHomes.com

1083 US Route 2, Berlin, VT 05602-8245
(802) 229-1592

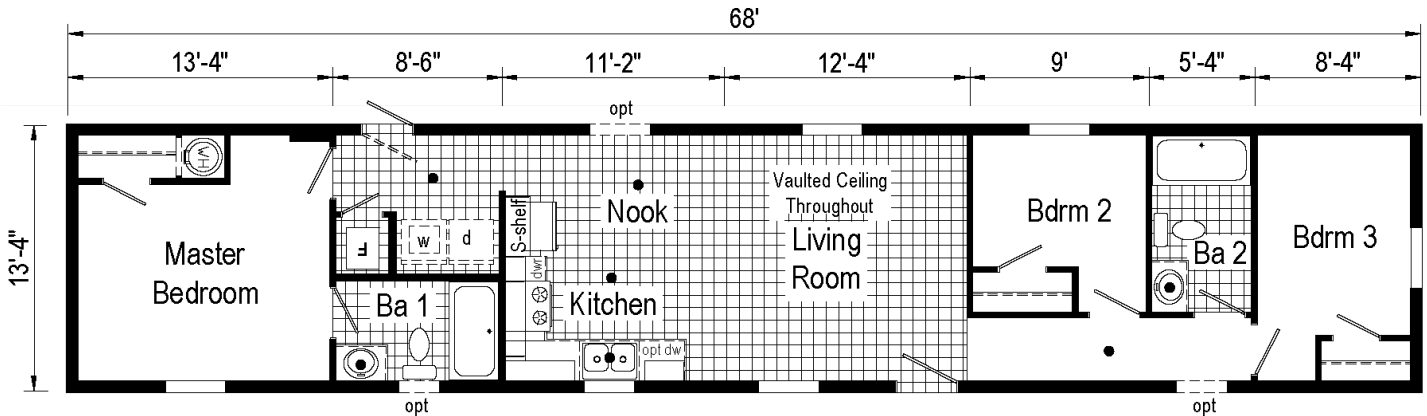

*Our Pricing includes Delivery,
Installation, Sewer & Water Hook-Up,
and Tax (if applicable)*

*[Please see a Home Consultant
& Installation Guide for details]*

Construction:

Single-Wide / Single-Section
Manufactured Home

Color: Clay / White

Upgrades

- Energy Star (Xtra Air Sealing & Insulation, 95% Eff Gas Furnace)
- **2' Stretch (1' in Bdrm 2 / 1' in Bdrm 3)**
- 7'6" Exterior Sidewall Height with Vaulted Ceilings
- **Extra Full Size Vinyl Window in Nook**
- Ice & Water Shield in Roof
- Protective Wind & Weather Wrap Under Siding
- 6-Panel Solid Fiberglass Rear Exterior Door
- Shutters on All Windows
- **Extra 24x36 Vinyl Window in Master Bath**
- Exterior Water Faucet
- 40 Gallon Water Heater
- Interior Water Shut-Off Valves Where Accessible
- In-house Main Water Line Shut-Off
- **Perimeter Heat Ducts & Registers**
- 4" Laminate Countertop Backsplashes Throughout
- 8" Deep Stainless Steel Kitchen Sink
- Single Lever Kitchen Faucet with Sprayer
- China Sinks in Bathrooms
- One Piece Fiberglass Tub/Shower Units in Bathrooms
- **Ceiling Fan with Light in Living Room**
- Ceiling Lights in Bedrooms
- (2) TV Jacks / Phone Jack / Plug for Electric Range

Installation Guide

Our Pricing includes DELIVERY, INSTALLATION and TAX (if applicable)

DOUBLE-WIDE & SINGLE-WIDE Home Installations Include:	VILLAGE HOMES	
SET, LEVEL & LAG HOME TOGETHER (DW)	✓	
SEAL MATE LINE / WALLS WITH EXPANSION FOAM	✓	
FINISH ROOFING	✓	
FINISH SIDING	✓	
HANG ALL INTERIOR DOORS / FINISH MATE WALL	✓	
SEAM CARPETS & FINISH FLOORING	✓	
INSTALL WATER LINE & HEAT TAPE TO SOURCE IN SLAB Run to Slab by Others	✓	
INSTALL SEWER LINE TO DRAIN(S) IN SLAB Run to Slab by Others	✓	
INSTALL ANCHORS / TIE DOWNS	✓	
INSTALL PREMIUM WHITE VINYL SKIRTING Rapid Wall & R-Cotec Insulated Products - Optional	✓	
INSTALL (2) SETS OF FIBERGLASS STEPS W/ RAILING	✓	
CLEAN HOME (Damp Wipe Surfaces, Broom & Vacuum)	✓	
REMOVE TRASH	✓	
REMOVE AXLES / TIRES (DW : Tires & Axles / SW : Tires)	✓	
1 YEAR MANUFACTURERS WARRANTY (New Homes)	✓	
10 YEAR LIMITED STRUCTURAL WARRANTY (New Homes)	✓	
HEATING / COOKING FUEL TANK(S) Buyer's Fuel Provider is Responsible for Tanks, Connections, Conversion to LP and Diagnostics	<i>Customer</i>	
CONNECT POWER SOURCE TO ELECTRICAL PANEL	<i>Optional</i>	
EXCAVATION / DRIVEWAY / LAWN	<i>Optional</i>	
CONCRETE SLAB OR FOUNDATION	<i>Optional</i>	
INSTALL PEDISTAL, METER & POWER LINE (Pole to Slab/Basement)	<i>Optional</i>	
ARTESIAN WELL OR CONNECT TO MUNICIPAL WATER Pressure Tank & Switch may be Required for Wells	<i>Optional</i>	
SEPTIC SYSTEM OR CONNECT TO MUNICIPAL SEWER	<i>Optional</i>	
GARAGE / DECK / PORCH	<i>Optional</i>	

FINANCING ASSISTANCE | IN-HOUSE CUSTOM PLAN DESIGN

EXCAVATION | SITE DEVELOPMENT | TRADES WELCOME

LAND FOR SALE | LOTS FOR RENT

ON-TIME & ON-BUDGET!



1083 US Route 2, Berlin, VT 05602 | (802) 229-1592 | sales@Village-Homes.com

**Vermont & New Hampshire's MOST TRUSTED builder
of affordable, quality Modular & Manufactured Homes**