

The Commodore Elite

3 Bedroom

2 Bath

28 x 60 (56) / 1,493 s.f.



www.GoVillageHomes.com

1083 US Route 2, Berlin, VT 05602-8245

(802) 229-1592

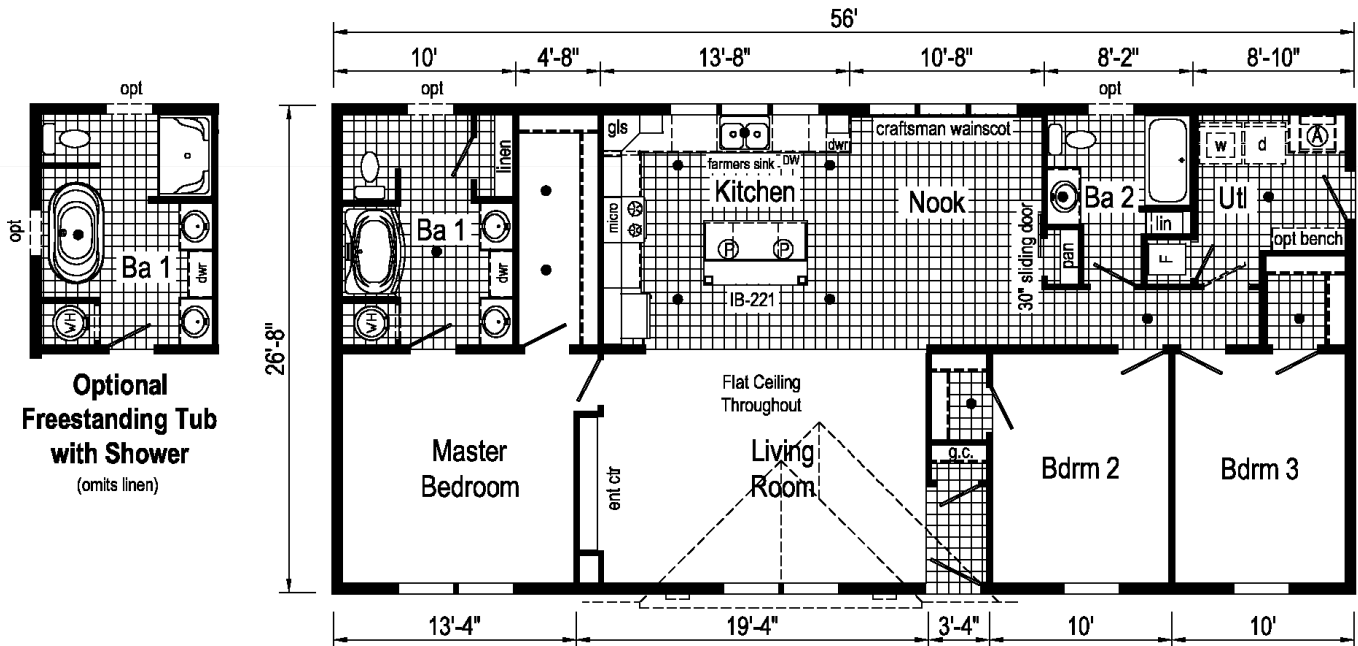

**Optional
Freestanding Tub
with Shower**
(omits linen)

Construction:

Double-Wide / Multi-Section
Manufactured Home

Color:

Greystone / Black

Featuring 10" Eave Overhangs

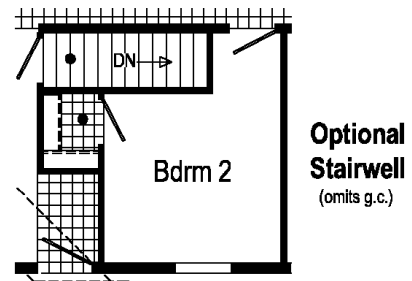

**Optional
Stairwell**
(omits g.c.)

Our Pricing includes Delivery, Installation, Sewer & Water Hook-Up, and Tax (if applicable)

[Please see an Installation Guide & Home Consultant for details]

Upgrades

- Energy Star (Extra Air Sealing & Insulation, 95% Eff Gas Furnace)
- Protective Wind Wrap & Ice Guard Roof Barrier
- **Flush Dormer with Full Eave**
- 24x36 Vinyl Windows in Master Bath & Bath 2
- 4-Lite Fiberglass Front Exterior Door
- 9-Lite Fiberglass Side Exterior Door
- Exterior Faucet / 40 Gal. Water Heater / Perimeter Heat
- Interior Water Shut-Offs / Main Water Shut-Off in Utility
- 200 Amp Service / Wired also for Electric Range
- **Cloud Grey Hardwood Shaker Cabinetry**
- Interior Door at Water Heater & Utility Room
- 36x60 One Piece FG Shower in Master Bath
- One Piece Tub/Shower in Bath 2
- Deluxe Paddle Fan w/ Light in Living Room
- **Industrial Stem Lights over Island**
- 3-Arm Hanging Light in Nook
- Ceiling Lights in Bedrooms
- Phone Jack / (2) TV Jacks

Village Homes has tried to ensure that our printed materials for all of our homes are comprehensive and factual. We reserve the right, however, to make changes without notice in pricing, options added, specifications, materials, etc. Due to continuous product development and improvements, your home may differ in manufacturing, color and options available at the time of construction. Specifications, dimensions and measurements on printed materials are approximates based on in-house design and/or engineering drawings. Any included images are artist renderings and not intended to be an accurate representation of the home. Renderings and floor plans may be shown with optional features or third party additions.

Rev. 11/14

Installation Guide

Our Pricing includes DELIVERY, INSTALLATION and TAX (if applicable)

DOUBLE-WIDE & SINGLE-WIDE Home Installations Include:

VILLAGE HOMES

SET, LEVEL & LAG HOME TOGETHER (DW)	✓	
SEAL MATE LINE / WALLS WITH EXPANSION FOAM	✓	
FINISH ROOFING	✓	
FINISH SIDING	✓	
HANG ALL INTERIOR DOORS / FINISH MATE WALL	✓	
SEAM CARPETS & FINISH FLOORING	✓	
INSTALL WATER LINE & HEAT TAPE TO SOURCE IN SLAB Run to Slab by Others	✓	
INSTALL SEWER LINE TO DRAIN(S) IN SLAB Run to Slab by Others	✓	
INSTALL ANCHORS / TIE DOWNS	✓	
INSTALL PREMIUM WHITE VINYL SKIRTING Rapid Wall & R-Cotec Insulated Products - Optional	✓	
INSTALL (2) SETS OF FIBERGLASS STEPS W/ RAILING	✓	
CLEAN HOME (Damp Wipe Surfaces, Broom & Vacuum)	✓	
REMOVE TRASH	✓	
REMOVE AXLES / TIRES (DW : Tires & Axles / SW : Tires)	✓	
1 YEAR MANUFACTURERS WARRANTY (New Homes)	✓	
10 YEAR LIMITED STRUCTURAL WARRANTY (New Homes)	✓	
HEATING / COOKING FUEL TANK(S) Buyer's Fuel Provider is Responsible for Tanks, Connections, Conversion to LP and Diagnostics	<i>Customer</i>	
CONNECT POWER SOURCE TO ELECTRICAL PANEL	<i>Optional</i>	
EXCAVATION / DRIVEWAY / LAWN	<i>Optional</i>	
CONCRETE SLAB OR FOUNDATION	<i>Optional</i>	
INSTALL PEDISTAL, METER & POWER LINE (Pole to Slab/Basement)	<i>Optional</i>	
ARTESIAN WELL OR CONNECT TO MUNICIPAL WATER Pressure Tank & Switch may be Required for Wells	<i>Optional</i>	
SEPTIC SYSTEM OR CONNECT TO MUNICIPAL SEWER	<i>Optional</i>	
GARAGE / DECK / PORCH	<i>Optional</i>	

FINANCING ASSISTANCE | IN-HOUSE CUSTOM PLAN DESIGN

EXCAVATION | SITE DEVELOPMENT | TRADES WELCOME

LAND FOR SALE | LOTS FOR RENT

ON-TIME & ON-BUDGET!



1083 US Route 2, Berlin, VT 05602 | (802) 229-1592 | sales@Village-Homes.com

**Vermont & New Hampshire's MOST TRUSTED builder
of affordable, quality Modular & Manufactured Homes**