

Optional Hutch

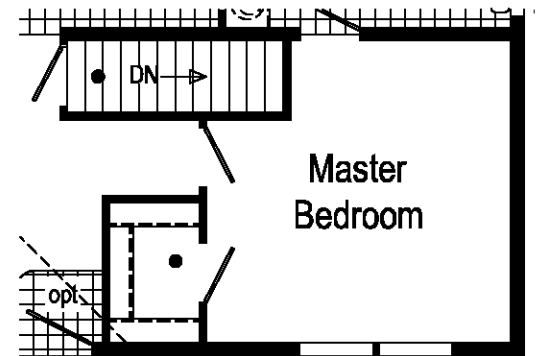

Optional Stairwell
(omits g.c.)

TD1006-P 2848 Approx. 1280 Sq. Ft.

- = Std. can light
- Ⓐ = Std frz spc, opt utl sink or bench.
- * = Std 4" staggered overhead cabinets with opt. flat ceiling

Blazer Select

Builder: Commodore Homes of Pennsylvania	Callout: 2848	Revisions		3/4/21	Scale: 1/8" = 1'-0"	Date: 1/14/21	Cust: -	Model/Eng. No.: TD1006-P
		Date	Number					
		6/23/20						
Title: Literature				3/1/21	Drawn By: OY	Reference: TD1005-P	S/N: ----	Pg.: LIT