

The Eastwood

3 Bedroom

2 Bath

14 x 72 (68) / 907 s.f.



www.GoVillageHomes.com

1083 US Route 2, Berlin, VT 05602-8245
(802) 229-1592

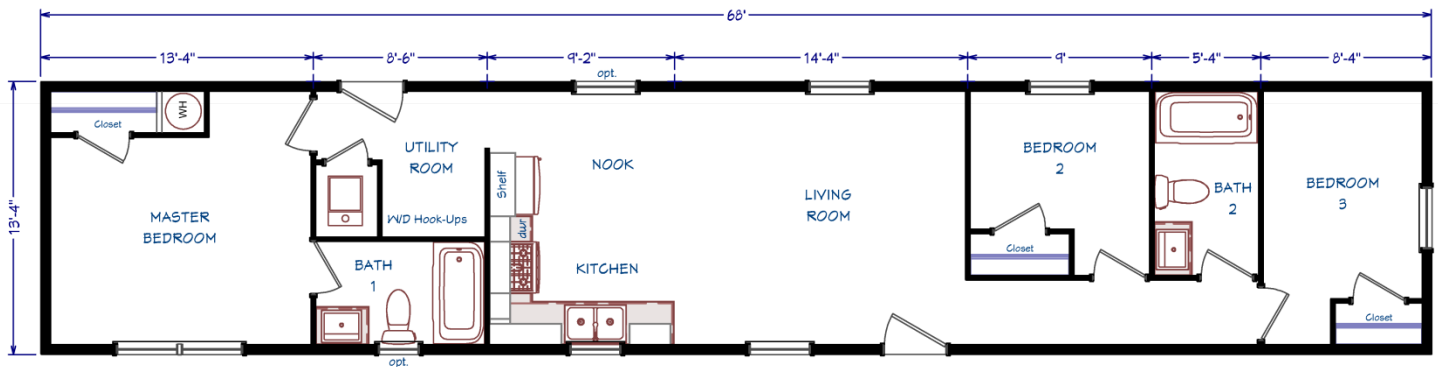

*Our Pricing includes Delivery,
Installation, Sewer & Water Hook-Up,
and Tax (if applicable)*

*[Please see a Home Consultant
& Installation Guide for details]*

Construction:
Single-Wide / Single-Section
Manufactured Home

Color: Greystone / Black

Upgrades

- Energy Star (Xtra Air Sealing & Insulation, 95% Eff Gas Furnace)
- **2' Stretch (1' in Bdrm 2 / 1' in Bdrm 3)**
- **Extra Full Size Vinyl Window in Nook**
- Ice & Water Shield in Roof
- Protective Wind & Weather Wrap Under Siding
- Shutters on All Windows
- Extra 24x36 Vinyl Window in Master Bath
- Exterior Water Faucet
- 40 Gallon Water Heater
- Interior Water Shut-Off Valves Where Accessible
- In-house Main Water Line Shut-Off
- Perimeter Heat Ducts & Registers
- 8" Deep Stainless Steel Kitchen Sink
- **Stainless Whirlpool 20 Cu. Ft. Refrigerator**
- **Stainless Whirlpool Deluxe Gas Range (Plug for Electric Range)**
- **Stainless Whirlpool Microwave over the Range**
- Hi-Rise Kitchen Faucet with Side Sprayer
- China Sinks in Bathrooms
- One Piece Fiberglass Tub/Shower Units in Bathrooms
- Ceiling Fan with Light in Living Room
- Ceiling Lights in Bedrooms
- (2) TV Jacks
- Phone Jack



Installation Guide

Our Pricing includes DELIVERY, INSTALLATION and TAX (if applicable)

DOUBLE-WIDE & SINGLE-WIDE Home Installations Include:	VILLAGE HOMES
SET, LEVEL & LAG HOME TOGETHER (DW)	✓
SEAL MATE LINE / WALLS WITH EXPANSION FOAM	✓
FINISH ROOFING	✓
FINISH SIDING	✓
HANG ALL INTERIOR DOORS / FINISH MATE WALL	✓
SEAM CARPETS & FINISH FLOORING	✓
INSTALL WATER LINE & HEAT TAPE TO SOURCE IN SLAB Line into Slab by Others	✓
INSTALL SEWER LINE(S) TO DRAIN(S) IN SLAB Line into Slab by Others	✓
INSTALL ANCHORS / TIE DOWNS	✓
INSTALL PREMIUM WHITE VINYL SKIRTING Rapid Wall & R-Cotec Insulated Products - Optional	✓
INSTALL (2) SETS OF FIBERGLASS STEPS W/ RAILING	✓
CLEAN HOME (Damp Wipe Surfaces, Broom & Vacuum)	✓
REMOVE TRASH	✓
REMOVE AXLES & TIRES	✓
MANUFACTURERS WARRANTY (New Homes)	✓
7-10 YEAR LIMITED STRUCTURAL WARRANTY (New Homes)	✓
HEATING / COOKING FUEL TANK(S) & INSTALLATION Buyer's Fuel Provider is Responsible for Tanks, Connections, Conversion to LP and Diagnostics	<i>Customer</i>
CONNECT ELECTRICAL WIRE IN SLAB TO ELECTRICAL PANEL	<i>Optional</i>
EXCAVATION / SLAB PREP / DRIVEWAY / GRADING / SEED & MULCH	<i>Optional</i>
CONCRETE SLAB / FOUNDTION	<i>Optional</i>
POLE / PEDISTAL / METER / DISCONNECT / CONDUIT / WIRE	<i>Optional</i>
WELL / CONNECT TO MUNICIPAL WATER (including line into slab) Pressure Tank & Switch may be Required for Wells	<i>Optional</i>
SEPTIC SYSTEM / CONNECT TO MUNICIPAL SEWER (including line into slab)	<i>Optional</i>
GARAGE / DECK / PORCH	<i>Optional</i>

1083 US Route 2, Berlin, VT 05602 | (802) 229-1592 | sales@Village-Homes.com

**Vermont & New Hampshire's MOST TRUSTED builder
of Modular & Manufactured Homes**