

# Westford Ranch

Our Pricing includes Delivery, Installation and Tax (if applicable)

[Please see an Installation Guide & Home Consultant for details]

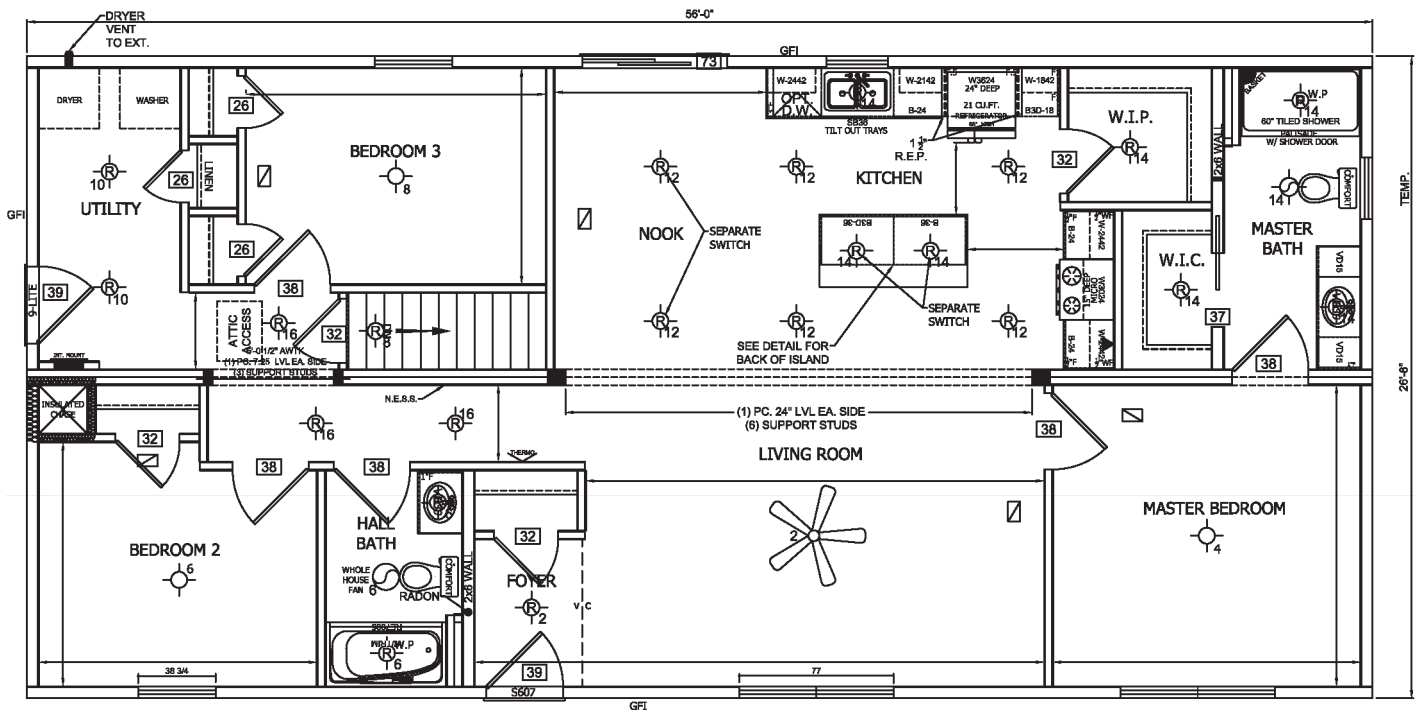

**Construction:** Modular  
**Size:** 28 x 56 / 1,493 s.f.  
**Color:** Shadow / White



1083 US Route 2, Berlin, Vermont 05602-8245

(802) 229-1592 | Sales@Village-Homes.com | [www.GoVillageHomes.com](http://www.GoVillageHomes.com)

# Upgrades

## CONSTRUCTION

60 PSF Roof Load with 5/8" Thick Sheathing  
R-49 Blown in Ceiling Insulation  
1" R-5 Continuous Foam Board Insulation over OSB Exterior Sheathing  
Insulated Chase for Furnace Return Air Duct

## EXTERIOR

Extra Shutters at Kitchen Window & Master Bath Window  
Extra Shutters at Bedroom #3 Window  
Plygem Truewall 4400 Vinyl Siding - Double 4" Traditional (.044" Thick)  
Plygem Silverline Double Hung Vinyl Windows (.27 U Factor / R-3.7)  
Window Grids between Glass - 6 over 1 (Top Sash Only)  
Tempered Glass at Master Bath Window

## EXTERIOR DOORS

Therma-Tru S607 Exterior Front Entry Door w/ 4-Lite Glass  
Therma-Tru S262 Exterior Side Entry Door w/ 9-Lite Glass  
Plygem Silverline Vinyl Sliding Glass Door in Nook (.27 U Factor / R-3.7)

## PLUMBING/HEATING

Updraft High Efficiency Gas Furnace (Shipped Loose)  
50 Gallon Electric Water Heater (Shipped Loose)  
Plumb for Washer

## ELECTRICAL

(5) Extra 4" LED Recessed Lights in Kitchen  
Paddle Fan with Light in Living Room  
Programmable Thermostat  
Phone Jack  
Wire & Vent for Electric Dryer

## APPLIANCES

Whirlpool Stainless Steel Side by Side Refrigerator  
Whirlpool Stainless Steel Smooth Top Electric Range  
Whirlpool Stainless Steel 6 Cycle Dishwasher  
Whirlpool Stainless Steel Microwave over Range  
Plumb Also for Gas Range  
Plumb for Water & Icemaker

## KITCHEN

42" Overhead Cabinets  
(2) Drawer Bank Base Cabinets  
Refrigerator End Panels with 24" Deep Overhead Cabinet  
Soft Close Drawers  
Picture Frame Molding at Island Back  
Single Lever Faucet w/ Pull Down Sprayer at Sink

## INTERIOR DOORS

36" Interior Passage Doors at Bedroom, Master Closet and Baths  
Pocket Door at Master Bedroom Closet

## BATHROOMS

Comfort Height Elongated Toilets  
36" x 60" Palisade Tile Shower in Master Bath

## SHIPPED LOOSE MATERIALS

Cased Opening Trim Kit - Living Room to Kitchen & Nook  
Underslung Heat Duct for Retail Installation  
Roof Shingles for Retail Installation  
Vinyl Outside Corner Posts for Retail Installation  
Master Bathroom Interior Door Trim/Casing for Retail Installation  
Cased Opening Trim Kit for Retail Installation

1083 US Route 2  
Berlin, Vermont 05602-8245  
(802) 229-1592  
Sales@Village-Homes.com

[www.GoVillageHomes.com](http://www.GoVillageHomes.com)



Village Homes has tried to ensure that our printed materials for all of our homes are comprehensive and factual. We reserve the right, however, to make changes without notice in pricing, options added, specifications, materials, etc. Due to continuous product development and improvements, your home may differ in manufacturing, color and options available at the time of construction. Specifications, dimensions and measurements on printed materials are approximates based on in-house design and/or engineering drawings. Any included images are artist renderings and not intended to be an accurate representation of the home. Renderings and floor plans may be shown with optional features or third party additions.

Rev. 11/14



# Installation Guide

Our Pricing includes DELIVERY, INSTALLATION and TAX (if applicable)

## MODULAR Home

### Installations Include:

## VILLAGE HOMES

HIRE CRANE & SET HOME ON FOUNDATION	✓	
INSTALL BASEMENT / CRAWL SPACE SUPPORTS AT MATE LINE	✓	
LAG TOGETHER WALLS, FLOOR & CEILING AT MATE LINE	✓	
SEAL MATE LINE / WALLS WITH EXPANSION FOAM	✓	
FINISH ROOFING	✓	
FINISH SIDING	✓	
BUILD BASEMENT STAIRS (If Applicable)	✓	
INSULATE BOX SILL ON HOME IN BASEMENT	✓	
HANG ALL INTERIOR DOORS / FINISH TRIM & DRYWALL	✓	
REPAIR DRYWALL CRACKS & PRIME TO MATCH	✓	
SEAM CARPETS & FINISH FLOORING	✓	
REPAIR MINOR FACTORY DEFICIENCIES	✓	
CLEAN HOME (Damp Wipe Surfaces, Broom & Vacuum)	✓	
REMOVE TRASH	✓	
INSTALL (2) SETS OF STEPS W/ RAILING (If Applicable)	✓	
MANUFACTURERS WARRANTY (New Homes)	✓	
7-10 YEAR LIMITED STRUCTURAL WARRANTY (New Homes)	✓	
FINISH COLLAR TIES IN ATTIC SPACE (Cape / Rafter Roof)	✓	
INSULATE, DRYWALL & PRIME VAULTED CEILING (Chalet) Finished Area Beyond Stairway	✓	
INSTALL & TRIM TRAPEZOID WINDOWS (Chalet)	✓	
INSTALL ANY FACTORY SUPPLIED RAILINGS (Cape / Chalet / 2-Story)	✓	

1083 US Route 2, Berlin, VT 05602 | (802) 229-1592 | sales@Village-Homes.com

**Vermont & New Hampshire's MOST TRUSTED builder  
of Modular & Manufactured Homes**